

COSSD PRODUCT CATALOGUE

for

C&R Insulating Ltd.

This product catalogue has been downloaded from **COSSD.com**. Listed products/services and their descriptions are shown as supplied by the title company—**COSSD** does not guarantee the accuracy or completeness of the information presented. Hosting of the PDF does not constitute an endorsement by **COSSD** of the products/services being offered.

6
WAYS TO USE
COSSD.com



SMARTPHONE / WEBSITE / DIGITAL EDITION / BOOK / iPad / GPS

Serving Alberta: Clairmont, Grande Prairie, Sexsmith, Whitecourt, Calgary, Edmonton, Hinton, Grand Cache, and Edson
Serving British Columbia: Fort St. John, Dawson Creek, Fort Nelson and Chetwynd

G&R Insulating Ltd. provides quality mechanical pipe insulation, oilfield buildings and other oil & gas related services to reduce heat loss, increase efficiency, productivity and profitability.

Services provided, but not limited to include:

- **Mechanical Pipe Insulating**
- **Oilfield buildings (Polyurethane Panels and Self-framed)**
- **Installation of glycol tubing**
- **Utilidor Construction**
- **Vessel and Tank Insulating**
- **Re-usable insulated blankets**

G&R Insulating was established in April 2000 and understands the importance of providing quality service and products by ensuring that our staff is well trained and capable of managing jobs in a safe and efficient manner.

Quality control is of the upmost importance to G&R Insulating. We pride ourselves on completing projects safely, on time, and within budget.



Mechanical Pipe Insulation

Energy efficient & cost effective solutions for the oil and gas industry

Insulating pipes is a crucial step in maintaining and protecting not only the longevity of the pipes themselves, but also protecting the material transported within the pipes or stored within a containment unit.

Without the correct insulation, the extreme weather conditions experienced in Alberta's and B.C.'s climate can easily cause the pipes to freeze in the harsh winter weather, or thicken oil making the flow of product slow and ineffective. This results in higher on-site risk of injury to employees, leakage, down time and loss of productivity.

Insulation protects the pipes from heat loss, increases efficiency and preserves product quality

When thermal insulation is applied to piping and mechanical systems, it is covered with aluminum cladding and fastened with stainless steel fab straps to protect the insulation.

There are substantial benefits to insulation:

- **Energy savings**
- **Increased personnel protection**
- **Process control**
- **Condensation control**
- **Noise reduction**
- **Reduction of greenhouse gas emissions**

Fiberglass

- Rated for systems up to 850°F (454°C)
- Easy Install
- Used for thermal and acoustic applications
- Durable and Affordable
- Various thicknesses available from 1" to 3" depending on the surface temperature of the pipe.
- Eco-friendly

Most common applications are on valves, flanges, exhaust systems, heat tracing heat exchangers, wellheads, tanks and vessels.

Mineral Wool

- Rated for piping systems running temperatures up to 1200°F (650°C)
- Lightweight
- Minimizes heat loss, reducing operating costs and maximizing energy savings
- Low dust when working with it
- Non-combustible
- Mold resistant
- Can be installed on hot surfaces without having to shut down and restart
- Maintains structural integrity under harsh operating conditions

Foamglas

- Light and rigid and made up of millions of completely sealed glass cells.
- Ideal for low temp pipe, tanks and vessels, but can be fairly costly.

Ideal for:

- Rated for temperatures from -450°F (-268°C) to 900°F (482°C)
- Zero water vapor permeability
- Fire protection
- Moisture resistance
- Vermin resistance
- Corrosion resistance

Calcium Silicate

- Provides exceptional strength and durability
- Rated for temperatures up to 1200°F (650°C)
- Exceptional structure strength and abuse resistant
- Recommended for use on power generation industries and petrochemical
- Available in thickness from 1"-3"
- Fast and easy to install

Snake Wrap

- R12 insulation value
- Helps with noise reduction
- Ideal for tubing lines, temporary lines, and lines to be accessed frequently
- Easily installed
- Remains flexible at very cold temperatures and will soften when temperatures exceed 220°F (104°C)
- Durable and excellent against punctures and tears

Reusable Insulated Blankets

Insulated covers are user friendly and can be installed or removed quickly. The covers are removable and reusable making them cost effective.

Covers are custom designed for proper fit therefore increasing energy efficiency and cost savings by:

- Improving product temperature regulation
- Reducing heat loss
- Durable
- Flexible
- Flame and chemical resistant
- Providing protection to staff and workers

All covers come with an identification tag to easily identify location and equipment the cover was specifically built for.

Tracer wrap insulation is commonly used on stainless steel tubing lines, as temporary insulation, hard access areas allow access for unions and to maintain continuous operating temperatures while providing personnel protection.

Covers and tracer wrap are fabricated with material good for temperatures from -40°F to 500°F.



Tanks and Vessels

Insulating tanks and vessels using polyurethane panels is yet another building service offered by G&R Insulating.

The panels used come in galvalume, galvanized, pre-painted and aluminum. The difference with these panels used, in comparison to the panels used for buildings, is that there is only skin applied to one side of the panel. On the opposite side, the polyurethane is cored to give it the flexibility of forming around the tank. Stainless steel strapping is used to attach the panels to the tanks.

Another method would be to insulate them with your choice of insulation (Mineral Wool, Foamglas, Calcium Silicate, Urethane, and Fiberglass) and metal jacketing banded on with stainless steel strapping. The most common insulations used are fiberglass and mineral wool.

Adding the appropriate building and skirting around production tanks to protect the meter controls, and properly insulating storage tanks and vessels helps improve all aspects of the oil and gas industry. It improves process control by preventing tanks from freezing or being heated by solar radiation. This increases safety level for both interior and exterior factors, ultimately resulting in increased cost savings.



When treated with the correct materials and insulation methods the advantages are overwhelming

- **Reduction of heat loss (cost savings)**
- **Reduction of CO2 emissions**
- **Frost protection**
- **Process control, ensuring the stability of the process temperature**
- **Noise reduction**
- **Condensation prevention**
- **Personal protection against high temperatures**

Serving Alberta: Clairmont, Grande Prairie, Sexsmith, Whitecourt, Calgary, Edmonton, Hinton, Grand Cache, and Edson
Serving British Columbia: Fort St. John, Dawson Creek, Fort Nelson and Chetwynd

Building Services

G&R Insulating offers a variety of building services for structures using Polyurethane Panels. Building services include, but are not limited to:

- Utilidors
- Pumpjack buildings
- Custom sized buildings
- Storage facilities
- Wellsite trailers
- Portable work camps, offices, worksite accomodations
- Mud shacks
- Portable washrooms

Polyurethane panels have an insulation value of R9-R19 depending on the thickness chosen. You can choose between 1 ½" and 3" thick and 47 ¼" wide. Panels can be ordered in lengths of 6' to 17' and either galvanized, galvalume, or pre-painted.

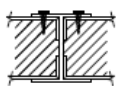

Panels are connected with varying types of extrusion as seen below.

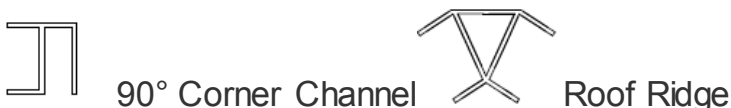
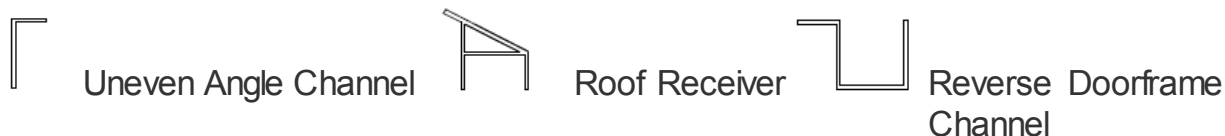
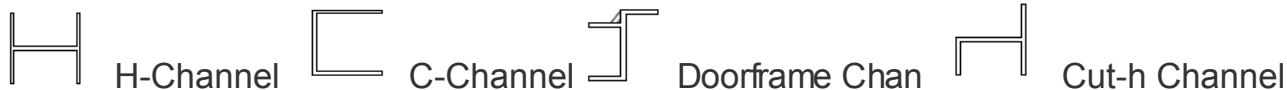

Serving Alberta: Clairmont, Grande Prairie, Sexsmith, Whitecourt, Calgary, Edmonton, Hinton, Grand Cache, and Edson
Serving British Columbia: Fort St. John, Dawson Creek, Fort Nelson and Chetwynd



G & R Insulating Ltd.

587.259.0800

Self-framer Buildings

Self-Frame buildings are a self-supporting structure that can be erected on site. They come in gable or shed style buildings, various color and material choices and have up to R40 insulation values.

Self-Frame buildings are ideal for compressor buildings, MCC buildings, wellhead shelters, water injection buildings, control rooms, office buildings and so much more.

Self-Frame buildings require no structural steel and are designed from an engineered panel. They have countless design combinations and provide a quick and easy construction.

The roof and wall panels of a self-frame building are usually single continuous length from eave to ridge line for gable style buildings. For shed style buildings, the continuous length is from low eave to high eave.

Smaller self-frame buildings can be fully assembled in house and transported to site.

Building designs come with a P.Engineers Stamped drawing for the province of Alberta when requested.



Safety and Certifications

G&R Insulating Ltd. is committed to an accident free workplace!

- **We protect our staff who work inside G&R Insulating buildings**
- **We protect the property and equipment used in the business process**
- **We protect the environment where work is being conducted**
- **We protect all visitors and customer's who we interact with**

The Health and Safety Program of our company is not static – we upgrade our program on a continuous basis. The success of a Health and Safety Program requires the participation and commitment of everyone within the organization. Within the program, the responsibilities for safety have been defined for management, supervisors, workers, sub-contractors, visitors, and the health and safety coordinator.

Recognizing the importance of an effective safety program, G&R Insulating Ltd. has developed a Health and Safety Manual in accordance to the standards and guidelines established by the Petroleum Industry. The certifying partner is ENFORM. We are SECOR certified and members of ISNetworld and Comply Works.

What do our certifications do for you?

When you work with a company who maintains and regularly updates their safety protocols and regulations, you know that you're working with a company who values you. When safety at the work place is of paramount importance, employees benefit from good working conditions and productivity increases.

For more information about G& R Insulating Ltd. safety regulations and policies, Glycol tracer systems, removable insulation covers, tracer wraps, polyurethane insulated panel buildings, metal self framing buildings and other pipe insulation methods, browse our website or contact us today.
www.grinsulating.com. 587-259-0800.

Contact Information

9318-81st Ave., Clairmont, AB., T8X 0M2

Ph: (587) 259-0800

Fax: 1-866-854-4638

Office Hours: 7 a.m to 5 p.m.

24 Emergency Contact: 780-814-0644

Email: info@grinsulating.com