



THE CONTAINMENT ANSWER
Secondary Containment Specialists

2018 Product & Service Catalogue

About TCA



The Containment Answer (TCA) is a full service secondary containment provider to the Agriculture, Earthworks, Engineering, and Canadian Oil & Gas Industries. We offer a complete selection of engineered steel containment solutions for various sizes of storage tanks and vessels. We also provide various types of geomembrane liners and geotextile fabrics for secondary containment applications as well as construction projects.

TCA has teamed with a southern Alberta manufacturing company to develop our own line of

secondary containment systems. All components of the system will be manufactured in Western Canada by our skilled Canadian labour force. Local manufacturing allows us to control costs as well as constantly improve upon the system.

TCA's local manufacturing agreement means a quick turnaround time from order to installation. No more backorders or wait times to delay your site construction. With the help of the engineering department we can design site specific containment solutions for the most difficult of projects

TCA offers professional installation of all of our secondary containment systems as well as liner installations and repairs. We fabricate and stock liners in Taber as well as our other warehouses to provide the customer with fast and efficient service. With independent dealers as well as TCA stocked warehouses in key areas of Saskatchewan and Alberta we are one of the leading distributors of secondary containment systems in Western Canada.

Distribution & Service Centers



Call 1-866-TCA-7771

Professionally Installed

Services

New System installation:

Services provided with new systems

- Design Assistance
- Delivery of system
- Fabric and liner installation
- Steel assembly
- Back fill
- Site clean up



Our crews work simultaneously with your crews, ensuring that system installation does not cause a delay to your schedule.

Existing System Expansion & Relocation:

We are experienced with all types of containment systems, both permanent and temporary. Our crews can dismantle, expand, or relocate any sized system.



Polyethylene Welding Services:

The use of specialized extrusion welding equipment combined with our experience and training allows TCA to provide versatile solutions across multiple industries.



Liner Replacement & Repair:

We offer onsite repair or replacement of any liner. Our portable extrusion welders can work with any polyethylene liner from any manufacturer in North America. We can repair all punctures, cuts, or tears in the liner. If you require a new liner in an existing system we will remove the old liner and replace it.



Secondary Containment Specialists

Containment Systems

ZDG Systems

All of our systems are made from G50 galvanized steel.
Each system includes a LLDPE or HDPE liner and geotextile fabric.

Environmentally Compliant in:

Alberta

Saskatchewan

British Columbia

Exceeds US regulations

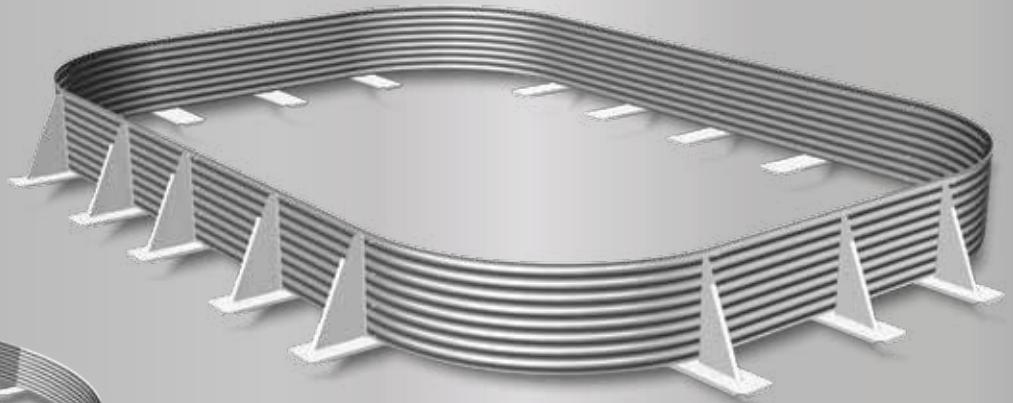
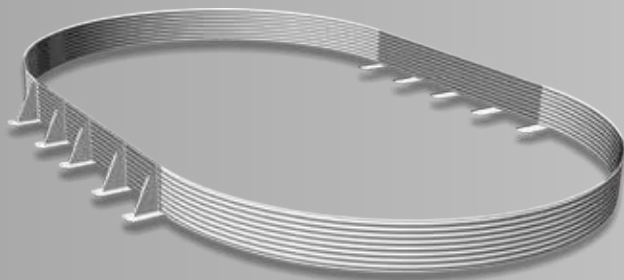

***ZDG systems are easily expanded
and 100% reusable.***

***Multiple wall heights make designing
your site simple, regardless of capacity
or area restrictions.***

***Each system is installed with minimal
maintenance required.***

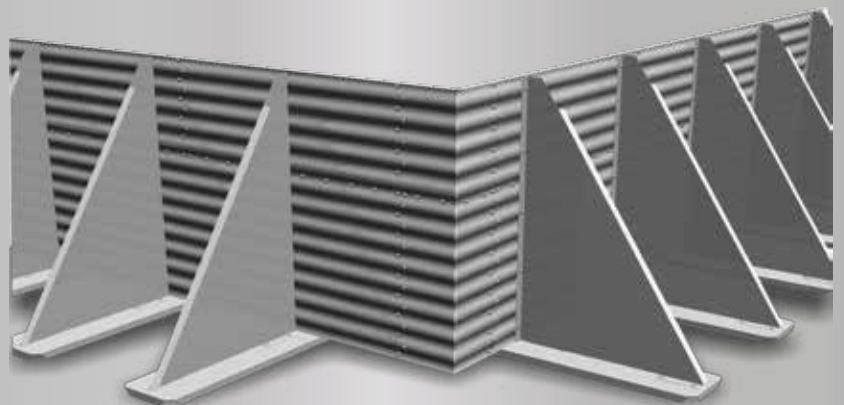
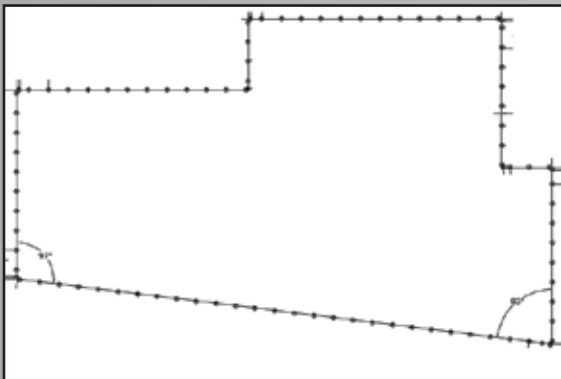
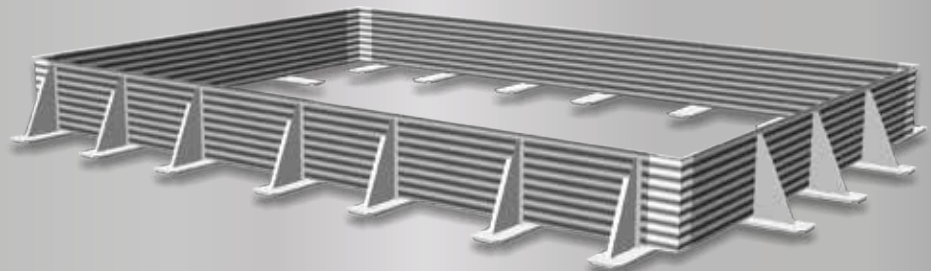

***55" wall combines 22" with 33" using special braces
and bolt pattern.***

All systems available in 14" 22" 33" 45" and 55" wall heights

Engineered Designs

Wedge-Lox Systems

Our boltless secondary containment system is fully engineered. Designed for fast assembly and take down, this system is ideal for temporary site locations. If needed the overlapping panel design gives the Wedge-Lox system the structural stability needed for permanent containment.

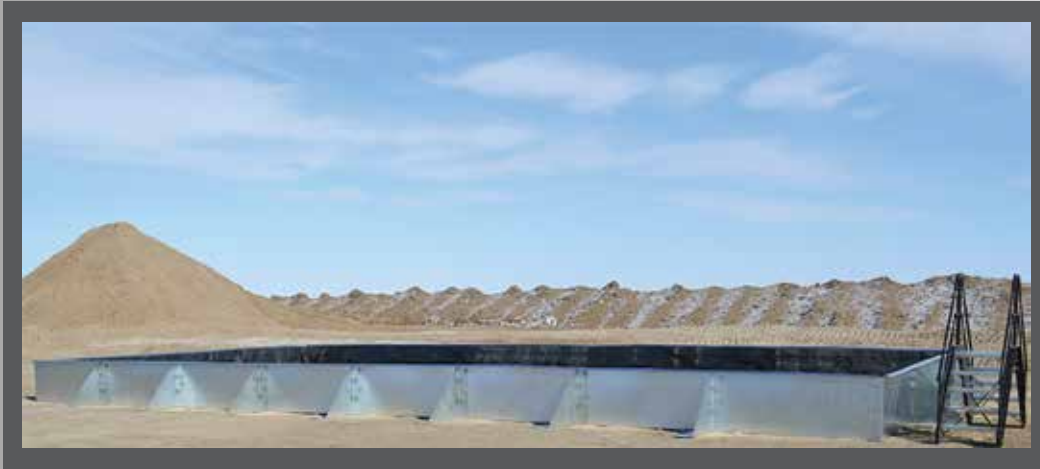

Assembly:

Line up punched holes
Insert wedge clip
Insert wedge (hammer tight)
Install liner
Screw on top clamp
Trim excess liner material

Available in 8' & 4' sections
15 gauge Galvanized steel
1 piece brace system
3" wide top cap
33" wall

More details at:
www.wedgelox.com



***Clip and wedge
eliminates need for
nuts and bolts***



***Single piece brace
design reduces on site
assembly.***

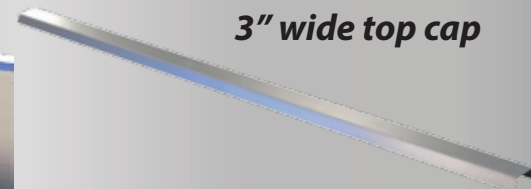
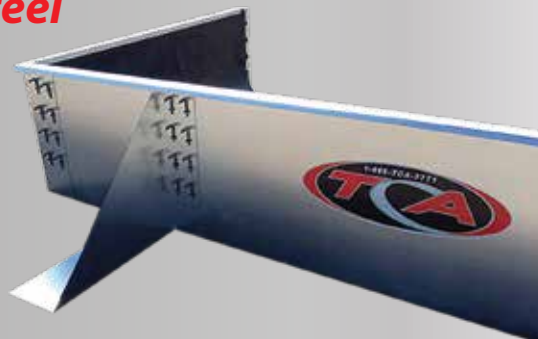

3" wide top cap

Industry Compliant

Liners & Fabrics

LLDPE & HDPE

Our secondary containment systems use 30 mil & 40 mil linear low density polyethylene (LLDPE). LLDPE has similar durability and resistance properties as high density polyethylene, but with increased flexibility. Increased flexibility reduces installation time and produces more consistent results, with less material wasted. Each sheet is welded together in our shop before shipping, and is ready to install when it arrives on site. The ability to weld the sheets together means there is no limit to the containment size, our liners can cover any size project.

Available in:
30mil smooth
30mil textured
40mil smooth
40mil textured
60mil HDPE

Property	Test	Frequency	Unit	Value = 30 mil	Value = 40 mil
Thickness (min. avg.)	ASTM D-5199	per roll	mm (in)	0.75 (0.02953)	1.0 (0.03937)
Sheet Density	ASTM D-1505	90,000 kg (200,000 lb)	g/ml	0.939	0.939
Carbon Black Content	ASTM D-1603 (3)	20,000 kg (45,000 lb)	%	2.0 - 3.0	2.0 - 3.0
Tensile Strength at Break	ASTM D-6693	9,000 kg (20,000 lb)	N/mm (lb/in)	20 (114)	27 (152)
Elongation at Break	ASTM D-6693	9,000 kg (20,000 lb)	%	800	800
Tear Resistance	ASTM D-1004	20,000 kg (45,000 lb)	N (lb)	70 (16)	100 (22)
Puncture Resistance	ASTM D-4833	20,000 kg (45,000 lb)	N (lb)	190 (42)	250 (56)
Oven Aging (HP-OIT)	ASTM D-5885	Per formulation	%	60	60
UV Resistance (HP-OIT)	ASTM D-5885	Per formulation	%	35	35



Pond liners for fresh water storage

Geotextile Fabric

Each of our containment units include 2 layers of 8 oz. woven or non-woven geotextile fabric. The fabric acts as additional protection to the liner itself. The fabric provides cushioning above and below the liner to prevent punctures.

We offer a complete line of woven and non-woven geotextile fabrics.

Pond liners
Filter cloth
Landscape fabric
Erosion control
Road construction

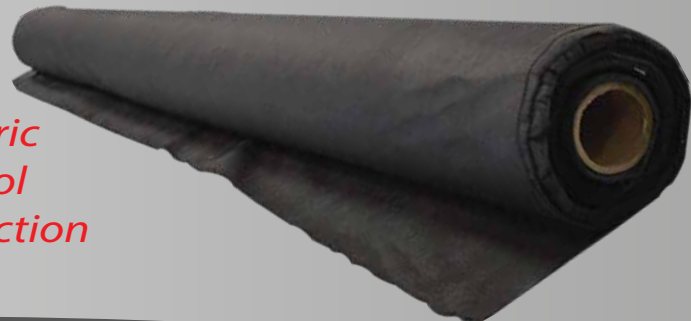

Environmentally Responsible

Accessories

Crossover stairs:

Fast assembly
Powder coat finish
Punched tread pattern
4, 5, 6 or 8 steps
3', 5', 10' horizontal extensions



Crossover Ladders:

40" or 50" heights
Shipped assembled



Tank Rings:

8" or 12" height available in any diameter
Rings are packed with aggregate for a level platform



Pipe Penetration Boots:

Supply only or installed. Our pipe penetrations work for any size pipe or support pile. From 2" to 14"
Custom sizes available upon request.

Locally Manufactured

Assembly

Assembly Stages

- 1) Pad levelled, piles driven, cut and uncapped.
- 2) Assemble braces and containment wall.
- 3) Unfold base layer of geotextile
- 3) Put liner in place
- 4) Weld in pipe penetrations
- 5) Install final containment panels
- 6) Lay top layer of geotextile
- 7) Add aggregate layer

Accessory stages

- 8) Tank foundation construction
- 9) Crossover stairs installed
- 10) Sting doors

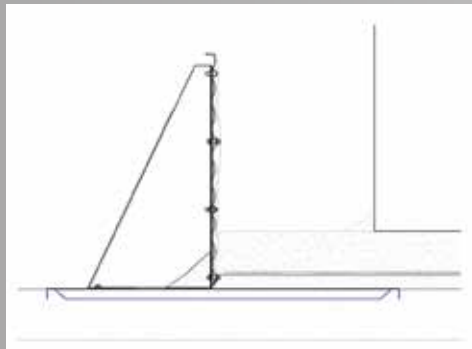

TCA punches the assembly holes in the manufacturing stage.

Punching the holes in the manufacturing process reduces on site assembly time, and eliminates the use of screws.

Bolted assembly systems require less maintenance.

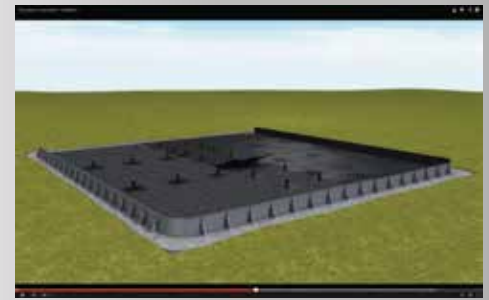
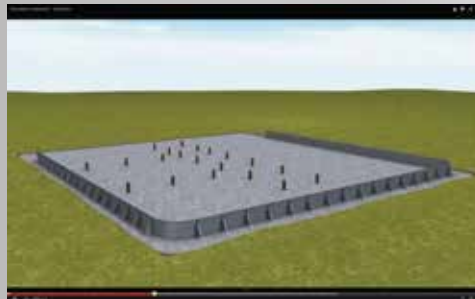
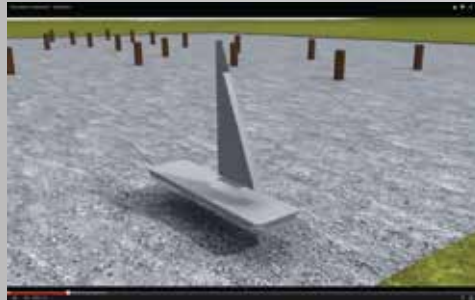

Call 1-866-TCA-7771

Sizing

Single Tank Systems



Tank system: 400BBL
Containment size: 36' Diameter
Wall height: 33"
Liner size: 44.4' x 44'
Containment shape: Round
Containment volume: 453BBL



Tank system: 400BBL
Containment size: 31' Diameter
Wall height: 45"
Liner size: 44.4' x 40'
Containment shape: Round
Containment volume: 504BBL



Tank system: 750BBL
Containment size: 42' Diameter
Wall height: 45"
Liner size: 44.4' x 40'
Containment shape: Round
Containment volume: 925BBL



Tank system: 1000BBL
Containment size: 51' Diameter
Wall height: 45"
Liner size: 66.6' x 60'
Containment shape: Round
Containment volume: 1273BBL

*Also available in radius
corner square and rectangle
for multiple tank facilities.*

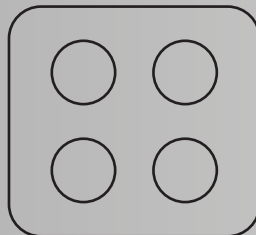
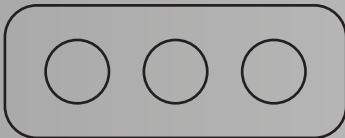

Double Tank Systems



Tank system: 2 x 400BBL
Containment size: 30' x 45'
Wall height: 33"
Liner size: 55.5' x 38'
Containment shape: Oblong
Containment volume: 515BBL



Tank system: 2 x 400BBL
Containment size: 27' x 41'
Wall height: 45"
Liner size: 44.4' x 50'
Containment shape: Oblong
Containment volume: 593BBL



Tank system: 2 x 750BBL
Containment size: 36' x 64'
Wall height: 33"
Liner size: 44.4' x 72'
Containment shape: Oblong
Containment volume: 902BBL



Tank system: 2 x 750BBL
Containment size: 33' x 52'
Wall height: 45"
Liner size: 44.4' x 62'
Containment shape: Oblong
Containment volume: 924BBL



Tank system: 2 x 1000BBL
Containment size: 33' x 61'
Wall height: 45"
Liner size: 44.4' x 72'
Containment shape: Oblong
Containment volume: 1108BBL

* Volume calculations do not include displacement of tank, or foundation

** Sizes shown are the top selling sizes. Custom sizing is available upon request



THE CONTAINMENT ANSWER
Secondary Containment Specialists

Scan to visit for a free quote:



www.thecontainmentanswer.com

Call for a dealer in your area:

1-866-TCA-7771

Head office:
6404 53 st
Taber, Alberta
T1G 2A2

Phone: 403-223-1113

E-mail: info@thecontainmentanswer.com